

10861-4/10861-4ND SINGLE HOLE TALL LAV FAUCET

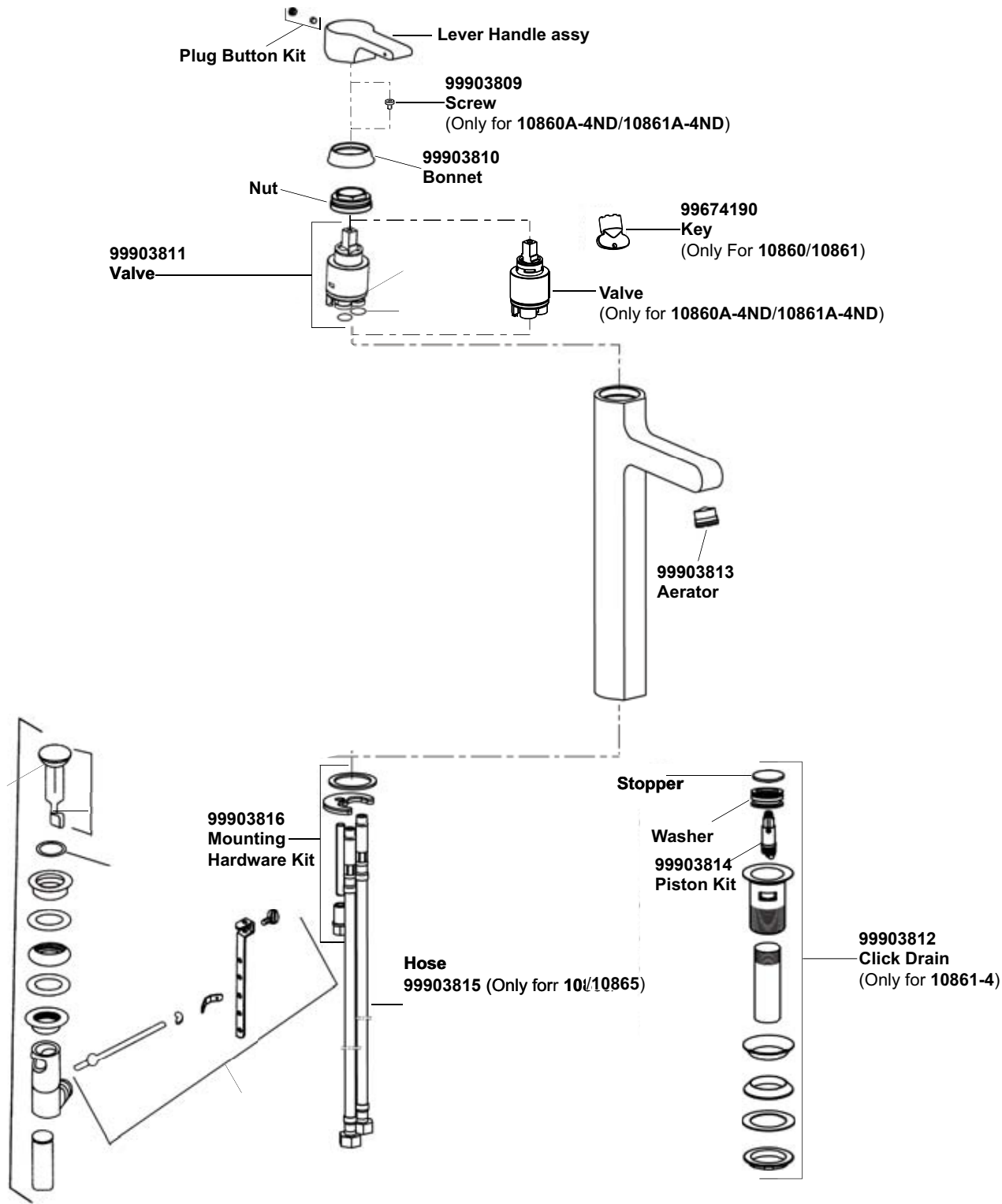

BEFORE YOU BEGIN

All information is based on the latest product information available at the time of publication. Kohler Co. reserves the right to make changes in product characteristics, packaging, or availability at any time without notice.

Please leave these instructions for the consumer. They contain important information.

- NOTES:**
1. Flush the water supply pipes thoroughly to remove any debris.
  2. An in line water filter must be used with this product.
  3. For new installations, assemble faucet and drain to lavatory before installing lavatory.
  4. Recommended working pressure: 1 to 5 bars.
  5. Maximum working pressure: 8 bars.

HANDLE OPERATION

Lift the handle gently. Turn left for hot water, right for cold water.

ROUGH-IN DIMENSIONS

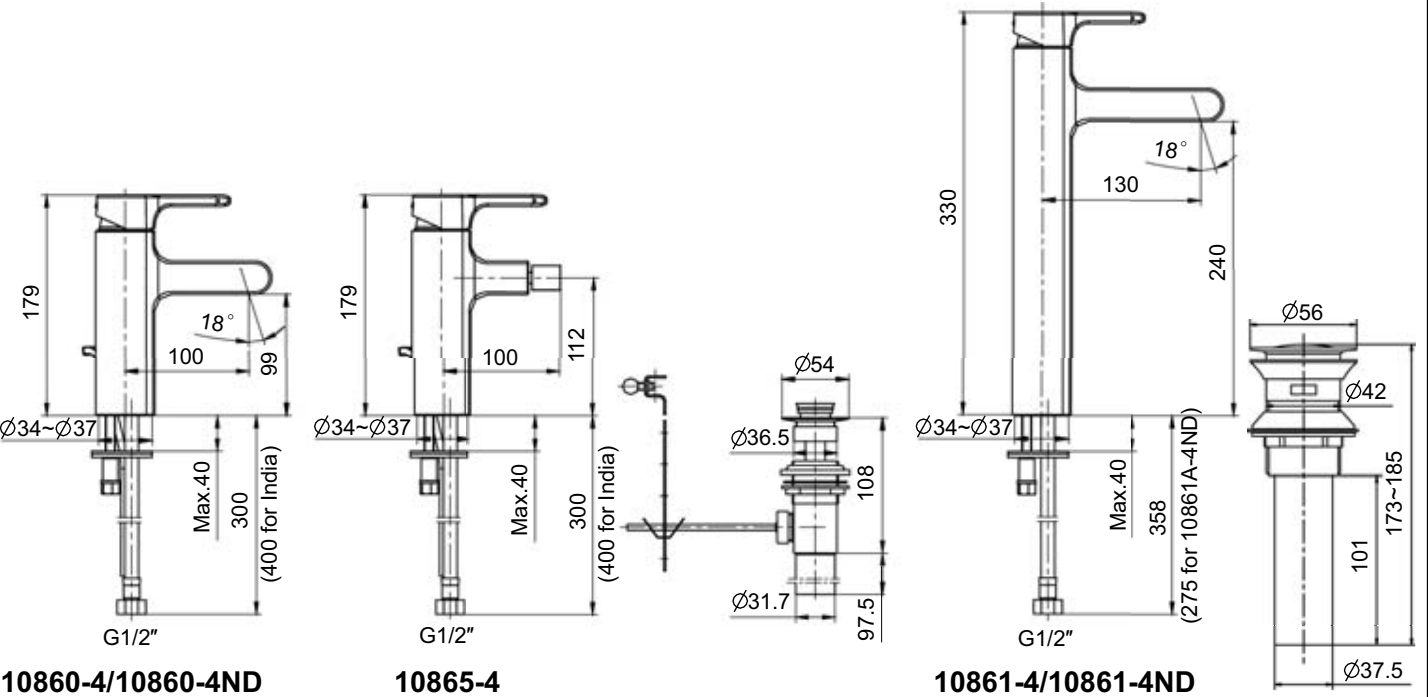

\*No drain for "ND" version

\*\*Color code must be specified when ordering